

A multi-purpose easy-to-use projector
with Full HD ideal use in
offices and schools



CP-DH300

Full HD (1,920x1,080pixels)

This projector offers Full HD (1,920 x 1,080 pixels) with a brightness of 3,000lm.

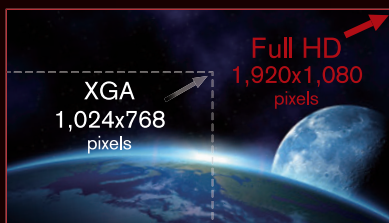

Intelligent Eco

Intelligent Eco mode is a feature developed by Hitachi, based on ImageCare® technology, that automatically changes the brightness of the lamp according to the level of the input signal. Lamp brightness is reduced when a darker image is projected and returns to normal when a brighter image is projected, eliminating unnecessary energy consumption from the lamp.

Connect Various Devices

Equipped with HDMI® terminals, these projectors can accommodate many types of AV devices. You can take advantage of the high resolution and high brightness that these projectors offer.

79" at 2m Wide angle

This projector is capable of projecting a 79" screen from a distance of 2m.

CP-DH300



DLP® Technology

DLP technology was invented, developed and is owned by Texas Instruments. The DLP chip is a digital semiconductor that contains millions of microscopic mirrors. This projector uses DLP technology to project images with amazing quality.



BrilliantColor™

BrilliantColor™ technology which is setting a new standard in color performance. BrilliantColor offers color processing to enhance color performance for rich, vibrant and accurate colors.



Wall Color Correction

This feature corrects the color of images projected on surfaces that are not white to prevent color differences between the source and projections.

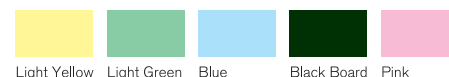

Specifications

Model name	CP-DH300	
Display system	1-Chip DLP®	
Display device	Size of effective display area	0.65" DLP® chip x 1, aspect ratio 16:9
	Number of pixels	2,073,600pixels(1,920 horizontal x 1,080 vertical) x1
Lens	Zoom	Manual (x1.3)
	Focus	Manual
Light source	210 W	
Screen size	1-8m (1.5-6m: recommendation)	
Light output (Brightness)	3,000lm (Bright mode)	
Contrast ratio	2,000:1(Bright mode)	
Speaker	2W x 1 mono	
Displayable scanning frequency	Horizontal	15-102kHz
	Vertical	23-120Hz
Terminals	COMPUTER IN	Mini D-sub 15-pin connector x 2
	MONITOR OUT	Mini D-sub 15-pin connector x 1
	VIDEO	RCA connector x 1
	S-VIDEO	Mini DIN 4-pin connector x 1
	COMPONENT VIDEO	Mini D-sub 15-pin connector x 2 (through COMPUTER IN 1/ (Y,Cb/Pb,Cr/Pr) COMPUTER IN 2)* D-Sub to 3 RCA adapter cable is necessary.
	HDMI	HDMI connector x 1
	AUDIO IN	Stereo mini connector x 1
	AUDIO OUT	Stereo mini connector x 1
Operating temperature	0-40°C at sea level	
	0-35°C at altitude of 0-1,499 m (with High Altitude Mode 2 [Normal])	
Operating humidity (RH)	10-90%RH(non-condensing)	
Power requirements	AC 100-120V (50/60Hz) : 2.9 A, AC 220-240V (50/60Hz) : 1.4 A	
Maximum power consumption	AC 100-120V: 280W, AC 220-240V: 260W	
Standby mode power consumption	0.5W at saving mode	
Standard outside dimensions (WxHxD)	265mm x 91.7mm x 223mm (10.4" x 3.6" x 8.8")	
	265mm x 81.5mm x 223mm (10.4" x 3.2" x 8.8") (Excluding lens and protruding part)	
Weight	Approx. 2.2 kg	
Accessories	Power cord, Computer cable, Remote control, Battery, User manual(Book, CD)	
Optional lamp	DT01463	

Environment

► Compliance with EU Directive RoHS¹

► Economic mode Economic mode provides power saving.

¹

RoHS is the acronym of "Directive 2011/65/EU of the European Parliament and of the Council of 8 June 2011 on the restriction of the use of certain hazardous substances in electrical and electronic equipment".

Dimensions

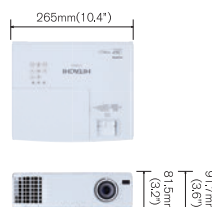

Projection Distance

On a horizontal surface

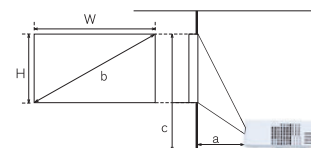

*Recommended throw distance: 1.5 ~ 6m.

Desired distance (m): a	Minimum screen size (Min zoom)			Maximum screen size (Max zoom)		
	Diagonal (inch): b	W (cm) x H (cm)	From base to top of image (cm): c	Diagonal (inch): b	W (cm) x H (cm)	From base to top of image (cm): c
1	30	67 x 38	39	39	87 x 49	51
1.5	45	101 x 57	59	59	131 x 74	77
2	60	134 x 76	79	78	174 x 98	102
2.5	75	167 x 94	98	98	217 x 122	128
3	90	201 x 113	118	117	261 x 147	154
3.5	105	234 x 132	138	137	304 x 171	179
4	120	267 x 151	158	157	347 x 196	205
4.5	136	301 x 169	177	176	391 x 220	230
5	151	334 x 188	197	196	434 x 244	256
5.5	166	367 x 207	217	215	477 x 269	282
6	181	401 x 226	236	235	521 x 293	307
6.5	196	434 x 244	256	254	564 x 317	333
7	211	467 x 263	276	274	607 x 342	358
7.5	226	501 x 282	295	294	651 x 366	384
7.7	232	513 x 289	303	300	664 x 373	392

Terminals

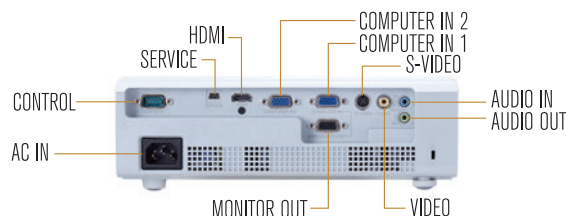

— Design and specifications are subject to change without notice.

- The projected images and comparison photos in this catalog are simulations.
- Do not use in places where there is a lot of water, dampness, steam, dust, soot or tobacco smoke. This may result in fire or malfunction.
- Optical components (lamp, color wheel, etc.) and cooling fans have limited service lives. They must be repaired or replaced if they are used for a long period of time.
- This projector uses a mercury lamp with high internal pressure. Because of its properties, this lamp may burst with a loud noise or burn out if struck or after it has been used for a period of time. The time until it bursts or burns out varies greatly according to differences between lamps and usage conditions. Turning the lamp's power on and off frequently shortens its service life.
- Do not turn projector on again for ten minutes after shutdown. Neglect can shorten the lifetime of the lamp. During use and immediately after use, do not touch anywhere near the lamp and the vents as these parts are extremely hot.
- HDMI, the HDMI Logo, and High-Definition Multimedia Interface are trademarks or registered trademarks of HDMI Licensing LLC in the United States and other countries.
- ImageCare is a trademark or a registered trademark of Royal Philips in the United States and other countries.
- DLP® and the DLP logo are registered trademarks of Texas Instruments and BrilliantColor™ is a trademark of Texas Instruments.
- All other trademarks are the properties of their respective owners.

HITACHI

Hitachi America, Ltd., Digital Media Division

Hitachi Home Electronics Asia (S) Pte, Ltd.

Hitachi Sales (Malaysia) Sdn. Bhd.

Hitachi Sales (Thailand), Ltd.

Hitachi (Hong Kong), Ltd.

Hitachi Sales Corp. of Taiwan

Hitachi Australia Pty Ltd.

Hitachi Europe Ltd., Digital Media Group Consumer Affairs Department Whitebrook Park, Lower Cookham Road, Maidenhead, Berkshire, SL6 8YA, UK Tel: +44-1628-585000 www.hitachidigitalmedia.com

Hitachi Maxell, Ltd.

2420 Fenton Street, Suite 200 Chula Vista, CA 91914, U.S.A. and Canada Tel: +1-800-225-1741 www.hitachi-america.us/digitalmedia

438A Alexandra Road #01-01/02/03, Alexandra Technopark, 119967, Singapore Tel: +65-6536-2520 www.hitachiconsumer.com.sg

Lot 12, Jalan Kemajuan, Bangi Industrial Estate, 43650 Bandar Baru Bangi, Selangor Darul Ehsan, Malaysia Tel: +60-3-8911-2670 www.hitachiconsumer.com.my

994, 996 Soi Thonglor, Sukhumvit 55 Road, Klongtonnua, Vadhana Bangkok 10110, Thailand Tel: +66-2335-5455 www.hitachi-th.com

18th Floor, Ever Gain Centre, 28 On Muk Street, Shatin, N.T., Hong Kong Tel: +852-2113-8883 www.hitachi-hk.com.hk

2nd Floor, No.65, Nanking East Road, Section 3, Taipei 104, Taiwan Tel: +886-2-2516-0500 www.hsct.com.tw

Suite 801, Level 8, 123 Epping Road, North Ryde NSW 2113, Australia Tel: +61-2-9888-4100 www.hitachi.com.au

292 Yoshida-cho, Totsuka-ku Yokohama, 244-0817, Japan http://www.hitachicorp/proj/

January 2014

ImageCare